

 **CALIBER**



SmartHome

Instruction manual for HWC 502



Index:

[No. 1 Caliber Smart Home app](#)

[No. 2 Register / Login](#)

[No. 3 Install device](#)

[No. 4 Add device\('s\)](#)

[No. 5 Install Chime](#)

[No. 6 Control device](#)

[No. 7 Profile](#)

[No. 8 Scene's & Automation](#)

[No. 9 Voice control](#)

[No. 10 Trouble shooting](#)

[No. 11 Specifications](#)



Click to jump to

What's in the box

Consult the checklist below for all components.

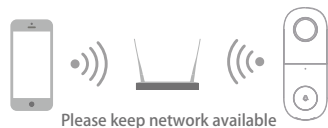
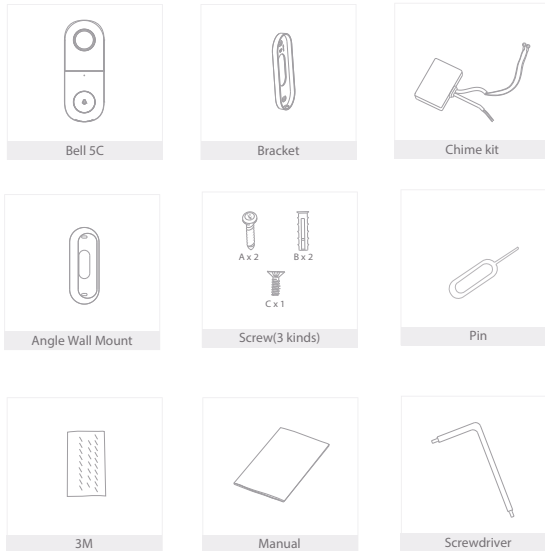

Note: Make sure the camera to be within range of the Wi-Fi network to ensure a successful connection between the camera and router.
Supported network: Wi-Fi 2.4GHz only

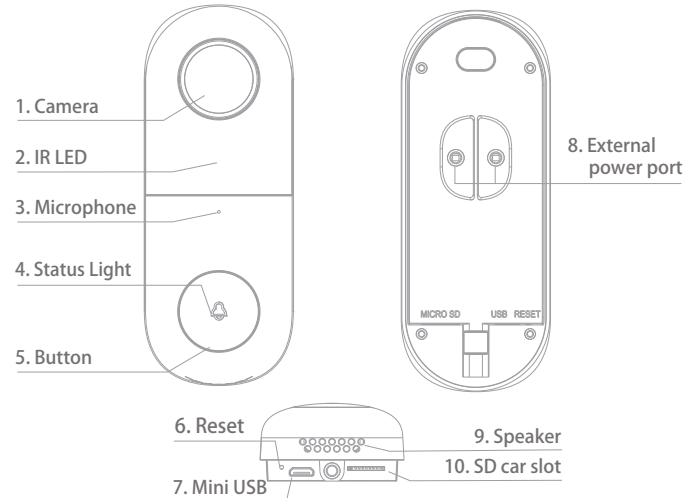

- 1. Camera**
- 1080p
- 2. IR led**
For night vision
- 3. Microphone**
2 way talk back
- 4. Status Light**
 - LED will blink rapidly in RED while searching for a new connection
 - LED will blink rapidly in BLUE while reconnecting
 - LED will be solid RED while restarting
 - LED will be solid BLUE while ON and connected
- 5. Button**
To ring the bell
- 6. Reset button**
To reset to factory settings
- 7. Micro USB slot**
Alternative power source 5V DC
- 8. External power port**
8-16V AC
- 9. Speaker**
- 10. micro SD card slot**
max. 128GB

Index:

- [No. 1 Caliber Smart Home app](#)
- [No. 2 Register / Login](#)
- [No. 3 Install device](#)
- [No. 4 Add device\('s\)](#)
- [No. 5 Install Chime](#)
- [No. 6 Control device](#)
- [No. 7 Profile](#)
- [No. 8 Scene's & Automation](#)
- [No. 9 Voice control](#)
- [No. 10 Trouble shooting](#)
- [No. 11 Specifications](#)



Click to jump to

Use your phone to scan the QR code below or search “Caliber Smart Home” in the app Store or Google play to download and install the app

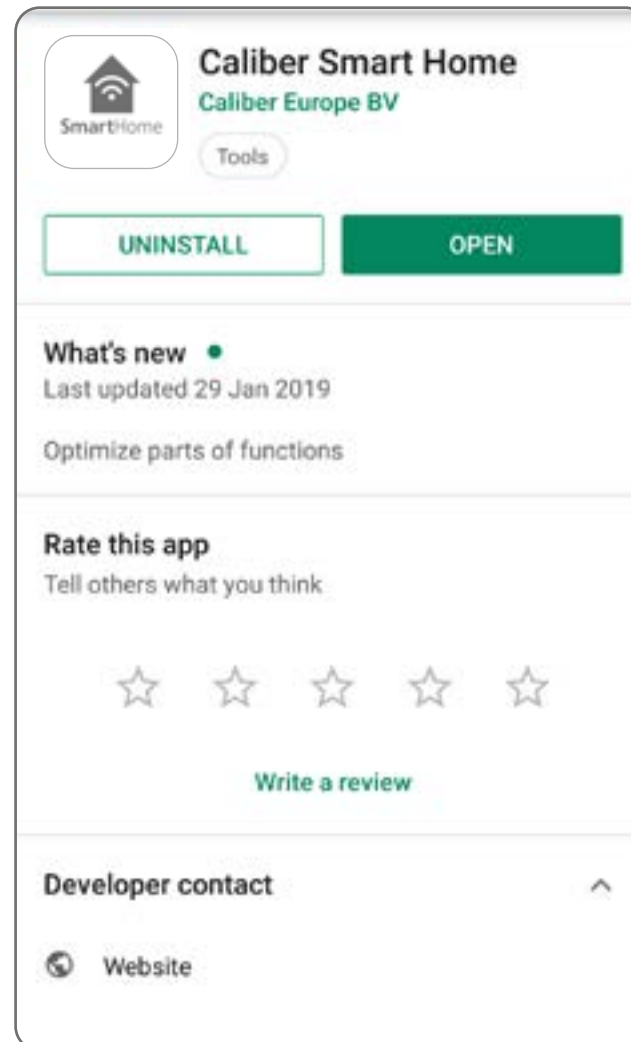

Index:

[No. 1 Caliber Smart Home app](#)

[No. 2 Register / Login](#)

[No. 3 Install device](#)

[No. 4 Add device\(s\)](#)

[No. 5 Install Chime](#)

[No. 6 Control device](#)

[No. 7 Profile](#)

[No. 8 Scene's & Automation](#)

[No. 9 Voice control](#)

[No. 10 Trouble shooting](#)

[No. 11 Specifications](#)

Register

Setup an account for 'Caliber Smart Home', or sign-in if you already have an account.

1. Tap "Register" in the lower center "img 1"
2. The system automatically determines your country / area. You can also select your country code by yourself.
Enter the cellphone number / E-mail and tap "Obtain verification code" "img 2"
note: Change to "register by phone" for using a phone number to register.
3. Enter the verification code you received "img 3". If you didn't received the verification code within 30min. please try the previous step again
4. Choose a password for your account "img 4", tap "Completed" to finish your registration.

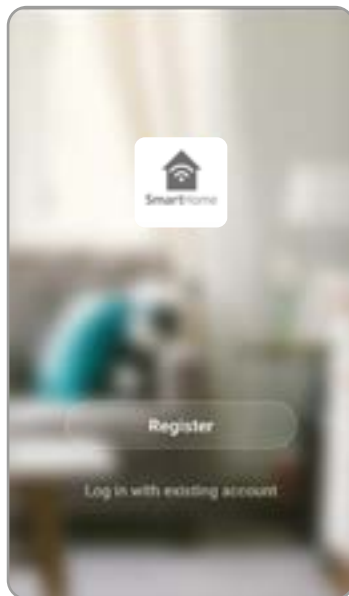

img 1



img 2

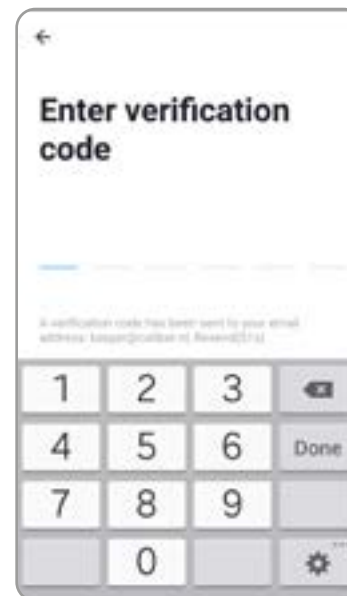

img 3

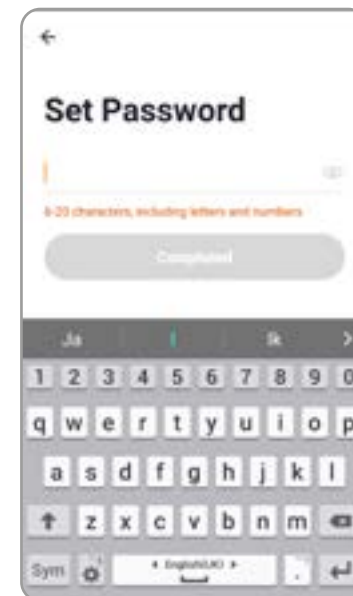

img 4

Index:

[No. 1 Caliber Smart Home app](#)

[No. 2 Register / Login](#)

[No. 3 Install device](#)

[No. 4 Add device\(s\)](#)

[No. 5 Install Chime](#)

[No. 6 Control device](#)

[No. 7 Profile](#)

[No. 8 Scene's & Automation](#)

[No. 9 Voice control](#)

[No. 10 Trouble shooting](#)

[No. 11 Specifications](#)

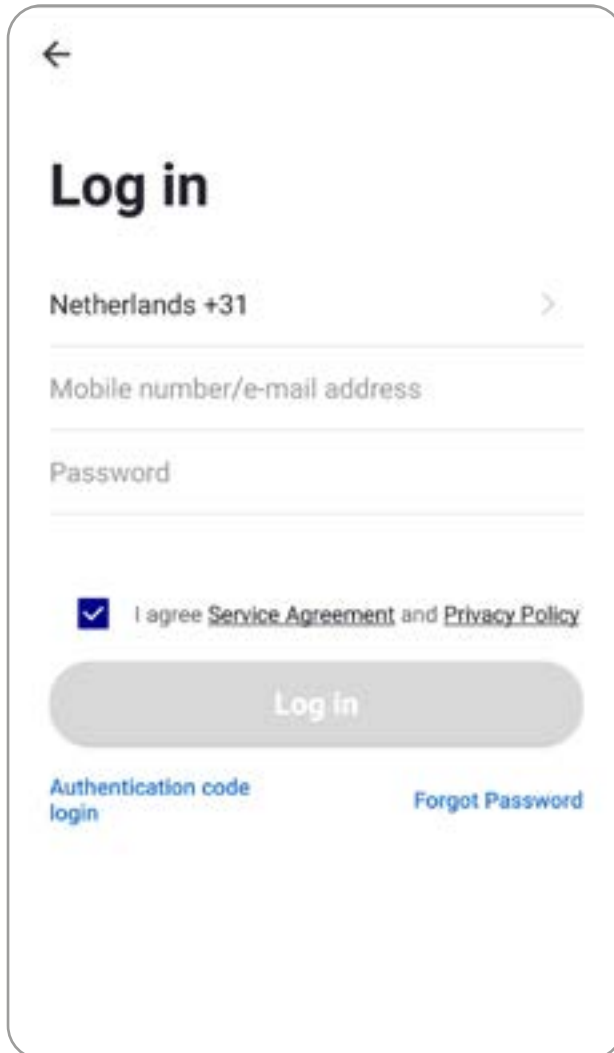

The image shows a mobile application login screen. At the top left is a back arrow. The title 'Log in' is centered. Below it, the country is set to 'Netherlands +31' with a right-pointing chevron. There are two input fields: 'Mobile number/e-mail address' and 'Password'. Below the password field is a checkbox with a checkmark and the text 'I agree [Service Agreement](#) and [Privacy Policy](#)'. A large grey 'Log in' button is centered below the checkbox. At the bottom left, there is a link 'Authentication code login' and at the bottom right, a link 'Forgot Password'.

Account+password sign-in

1. The system will automatically determine your country / area or you could select manually
2. Enter your registered cellphone number or email and password, sign in to the system

Index:

[No. 1 Caliber Smart Home app](#)

[No. 2 Register / Login](#)

[No. 3 Install device](#)

[No. 4 Add device\('s\)](#)

[No. 5 Install Chime](#)

[No. 6 Control device](#)

[No. 7 Profile](#)

[No. 8 Scene's & Automation](#)

[No. 9 Voice control](#)

[No. 10 Trouble shooting](#)

[No. 11 Specifications](#)

Forgot password

If you forgot your account of “Caliber Smart Home”, you can reset the account password by “Forgot password”

1. Tap “Forgot password”, as shown in “img 1”
2. The system automatically determines your country / area. You can also select your country code by yourself. Enter the cellphone number/E-mail and tap “Obtain verification code”, as shown in “img 3”
3. Enter the verification code you received “img 3”. If you didn’t received the verification code within 30min. please try the previous step again.
4. Choose a password for your account “img 4”, tap “Completed” to finish your registration.

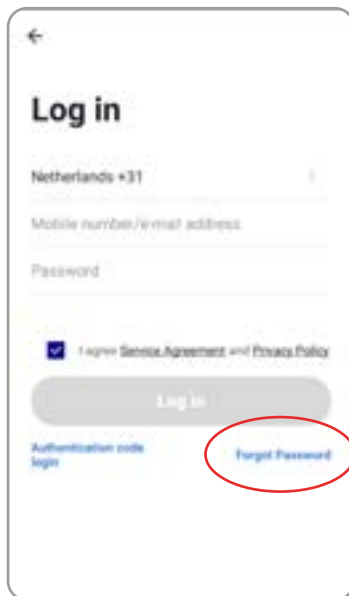

img 1

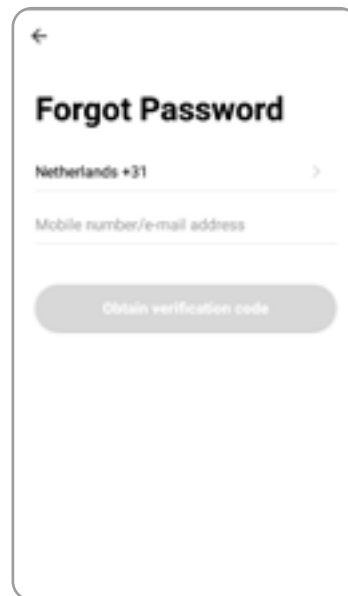

img 2



img 3

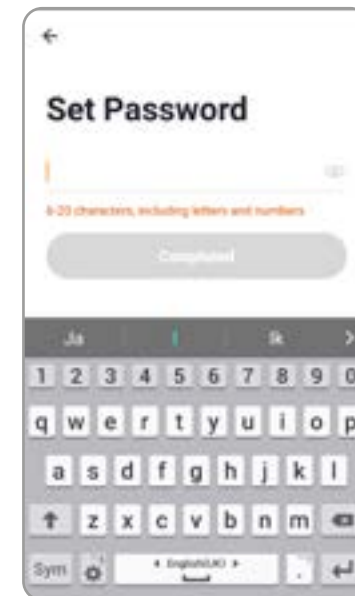

img 4

Index:

[No. 1 Caliber Smart Home app](#)

[No. 2 Register / Login](#)

[No. 3 Install device](#)

[No. 4 Add device\(s\)](#)

[No. 5 Install Chime](#)

[No. 6 Control device](#)

[No. 7 Profile](#)

[No. 8 Scene's & Automation](#)

[No. 9 Voice control](#)

[No. 10 Trouble shooting](#)

[No. 11 Specifications](#)

Doorbell Installation

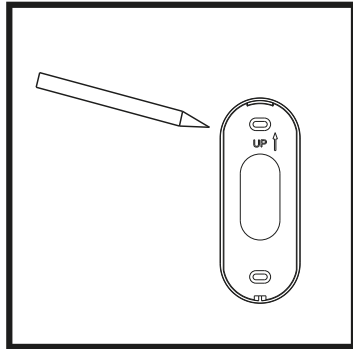

1. Mark screws position

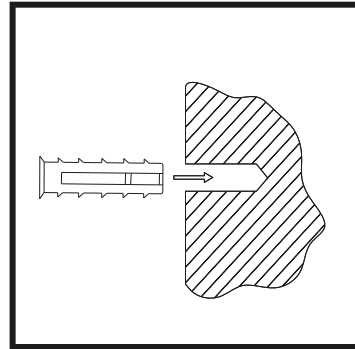

2. Nail expansion screw

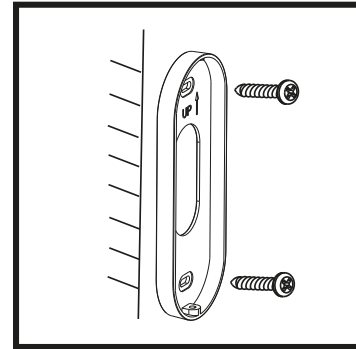

3. Fix bracket

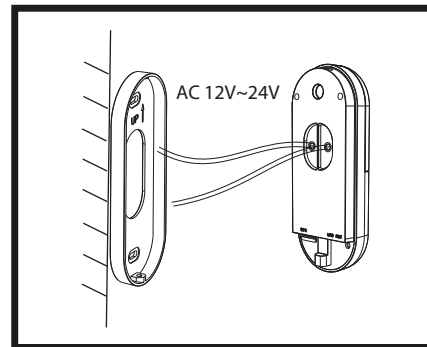

4. Install the doorbell into the bracket

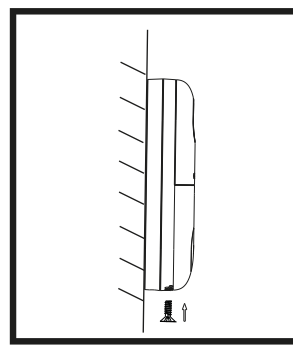

5. Install the doorbell into the bracket
Fix it with the C screw

Index:

[No. 1 Caliber Smart Home app](#)

[No. 2 Register / Login](#)

[No. 3 Install device](#)

[No. 4 Add device\('s\)](#)

[No. 5 Install Chime](#)

[No. 6 Control device](#)

[No. 7 Profile](#)

[No. 8 Scene's & Automation](#)

[No. 9 Voice control](#)

[No. 10 Trouble shooting](#)

[No. 11 Specifications](#)

Doorbell Installation Angle Mount

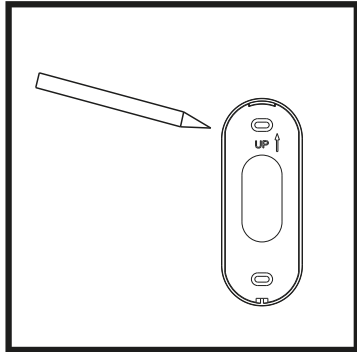

1. Mark screws position

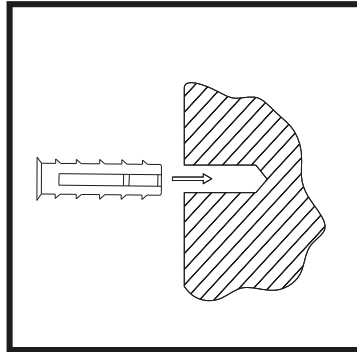

2. Nail expansion screw

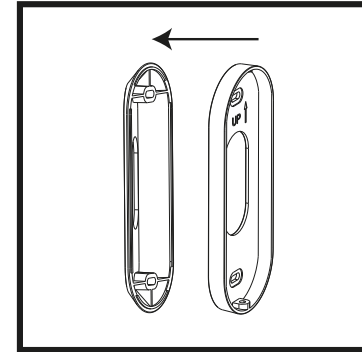

3. Fit the mounting bracket to the angle wall mount

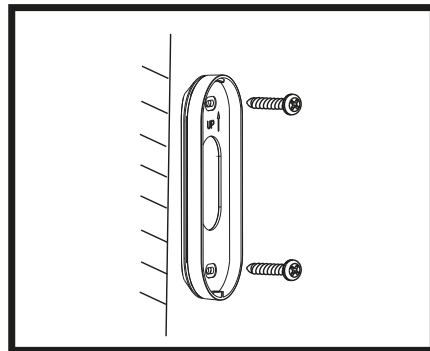

4. Fix bracket

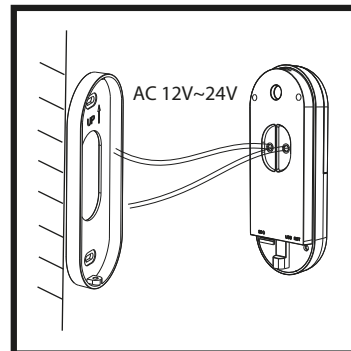

5. Install the doorbell into the bracket

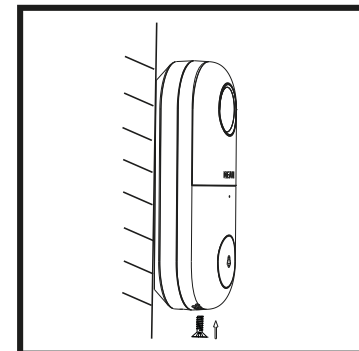

6. Angle mounted
Fix it with the C screw

Index:

[No. 1 Caliber Smart Home app](#)

[No. 2 Register / Login](#)

[No. 3 Install device](#)

[No. 4 Add device\('s\)](#)

[No. 5 Install Chime](#)

[No. 6 Control device](#)

[No. 7 Profile](#)

[No. 8 Scene's & Automation](#)

[No. 9 Voice control](#)

[No. 10 Trouble shooting](#)

[No. 11 Specifications](#)

1. Go to the app, tap “+” in the upper right of this page to add device’s as shown in the picture to the left.
2. In this case, select “Doorbell camera”
3. Please make sure the device’s indicator light flashes quickly, tap “Next step” to continue.
4. Enter your WiFi-password
5. Next the app will show a QR code. Hold it in front of the camera lens until the doorbell-camera makes the confirming sound.
6. When successfully added, you can rename the camera and choose where it’s located
7. Choose your [chime setup](#)

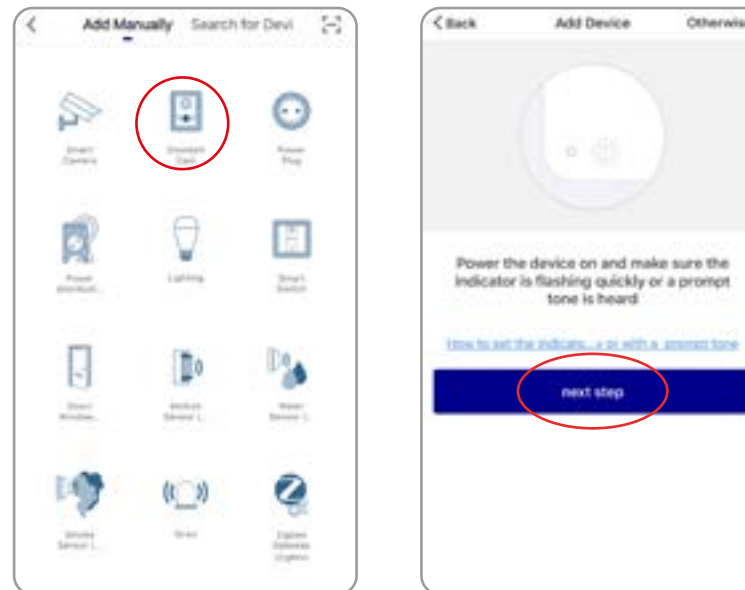
**Index:**[No. 1 Caliber Smart Home app](#)[No. 2 Register / Login](#)[No. 3 Install device](#)[No. 4 Add device\('s\)](#)[No. 5 Install Chime](#)[No. 6 Control device](#)[No. 7 Profile](#)[No. 8 Scene's & Automation](#)[No. 9 Voice control](#)[No. 10 Trouble shooting](#)[No. 11 Specifications](#)

Connecting the HWC502 doorbell camera.

In most cases there will be a doorbell adapter 8-16V AC already in the house. The diagram below shows what it looks like:

1. Current / old situation

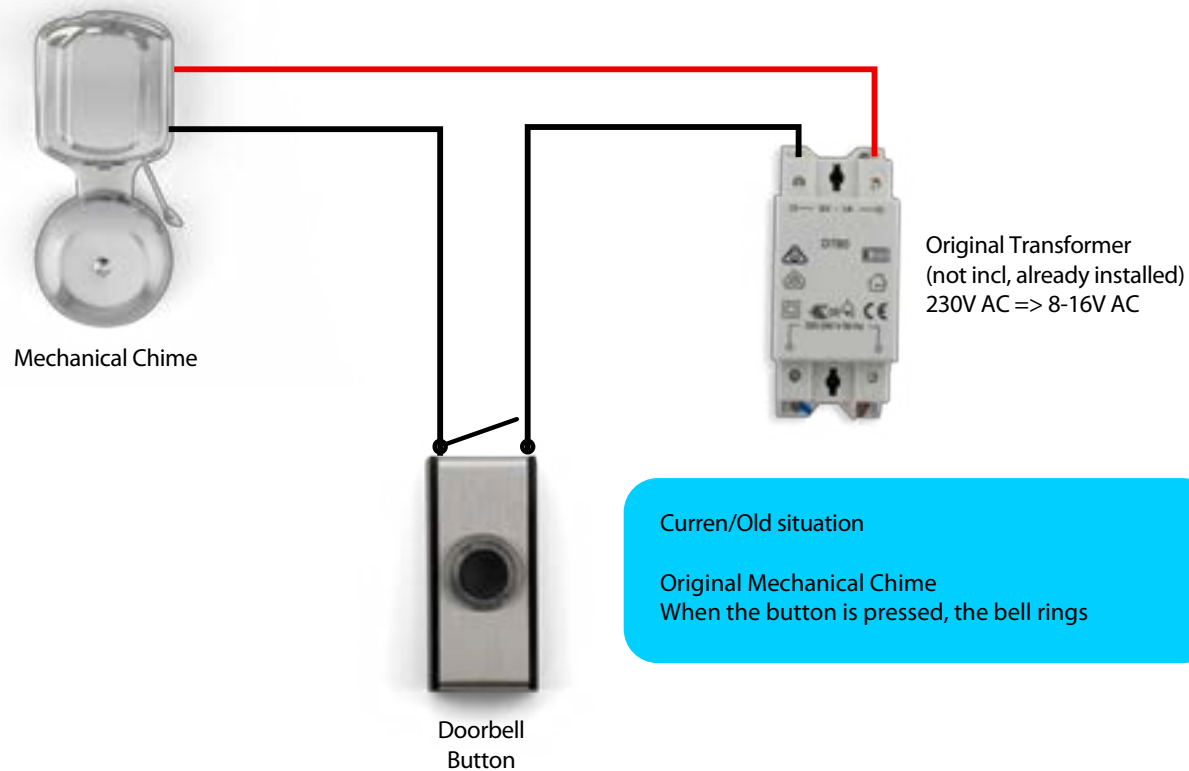

Index:

[No. 1 Caliber Smart Home app](#)

[No. 2 Register / Login](#)

[No. 3 Install device](#)

[No. 4 Add device\('s\)](#)

[No. 5 Install Chime](#)

[No. 6 Control device](#)

[No. 7 Profile](#)

[No. 8 Scene's & Automation](#)

[No. 9 Voice control](#)

[No. 10 Trouble shooting](#)

[No. 11 Specifications](#)

Connecting HWC502 with no extra chime

3. No extra Chime

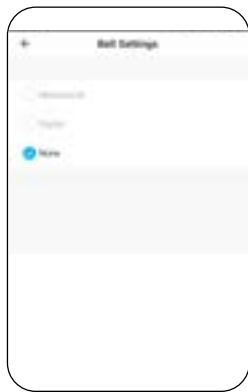

(Phone app)



Original Transformer
(not incl, already installed)
230V AC => 8-16V AC

No extra Chime

When the button is pressed, the HWC502 rings on your phone and a sound is heard from the camera's speaker

Doorbell
HWC502

Index:

[No. 1 Caliber Smart Home app](#)

[No. 2 Register / Login](#)

[No. 3 Install device](#)

[No. 4 Add device\('s\)](#)

[No. 5 Install Chime](#)

[No. 6 Control device](#)

[No. 7 Profile](#)

[No. 8 Scene's & Automation](#)

[No. 9 Voice control](#)

[No. 10 Trouble shooting](#)

[No. 11 Specifications](#)

Connecting a digital chime.

If you want a chime to “ring” or “ding dong” on any location within the WiFi range, please install as described below. The HWC501CH is sold separately:

4. Digital Chime

Index:

[No. 1 Caliber Smart Home app](#)

[No. 2 Register / Login](#)

[No. 3 Install device](#)

[No. 4 Add device\(s\)](#)

[No. 5 Install Chime](#)

[No. 6 Control device](#)

[No. 7 Profile](#)

[No. 8 Scene's & Automation](#)

[No. 9 Voice control](#)

[No. 10 Trouble shooting](#)

[No. 11 Specifications](#)

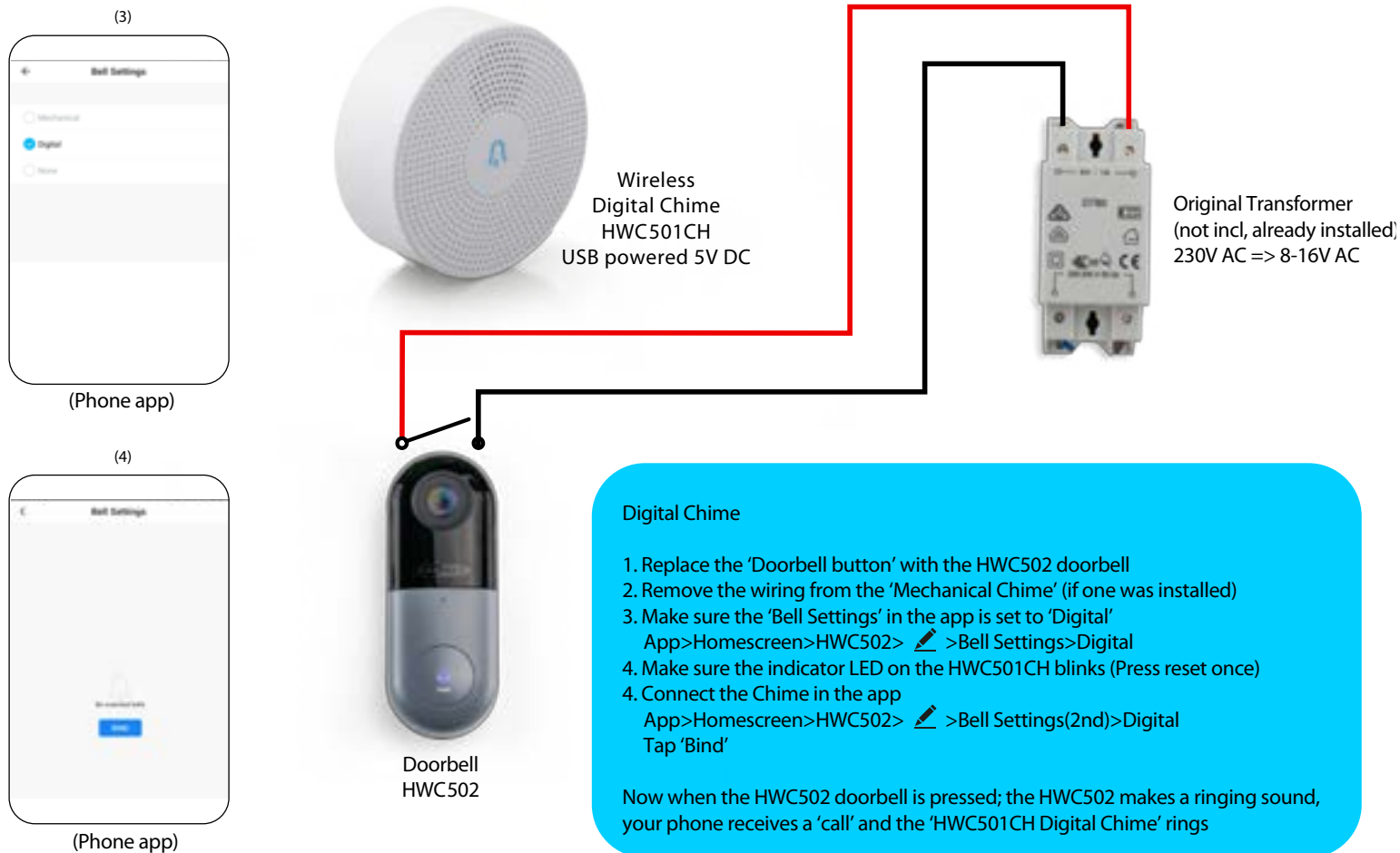

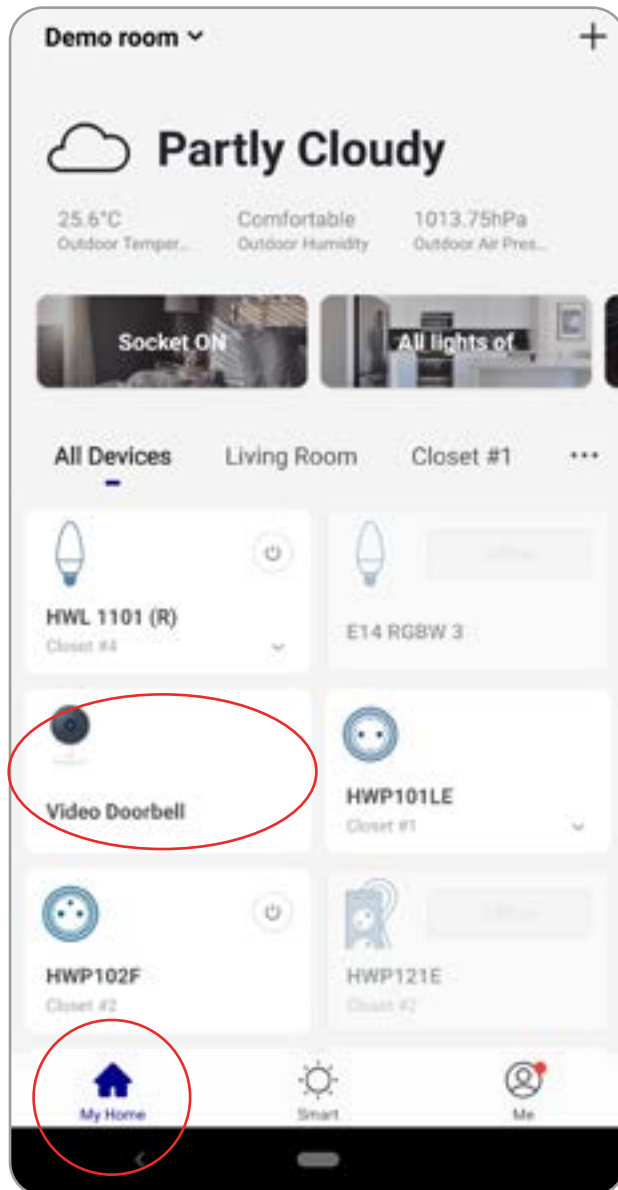

Control device

After the device is connected successfully, tap “My Home” at the bottom. The device name shows in the list. Tap it to enter the control panel of the device (Doorbell cam)

Remarks:

When device is online, operation via shortcuts is supported; When the device is offline, device displays “device is offline” and is greyed out.

Index:

[No. 1 Caliber Smart Home app](#)

[No. 2 Register / Login](#)

[No. 3 Install device](#)

[No. 4 Add device\(s\)](#)

[No. 5 Install Chime](#)

[No. 6 Control device](#)

[No. 7 Profile](#)

[No. 8 Scene's & Automation](#)

[No. 9 Voice control](#)

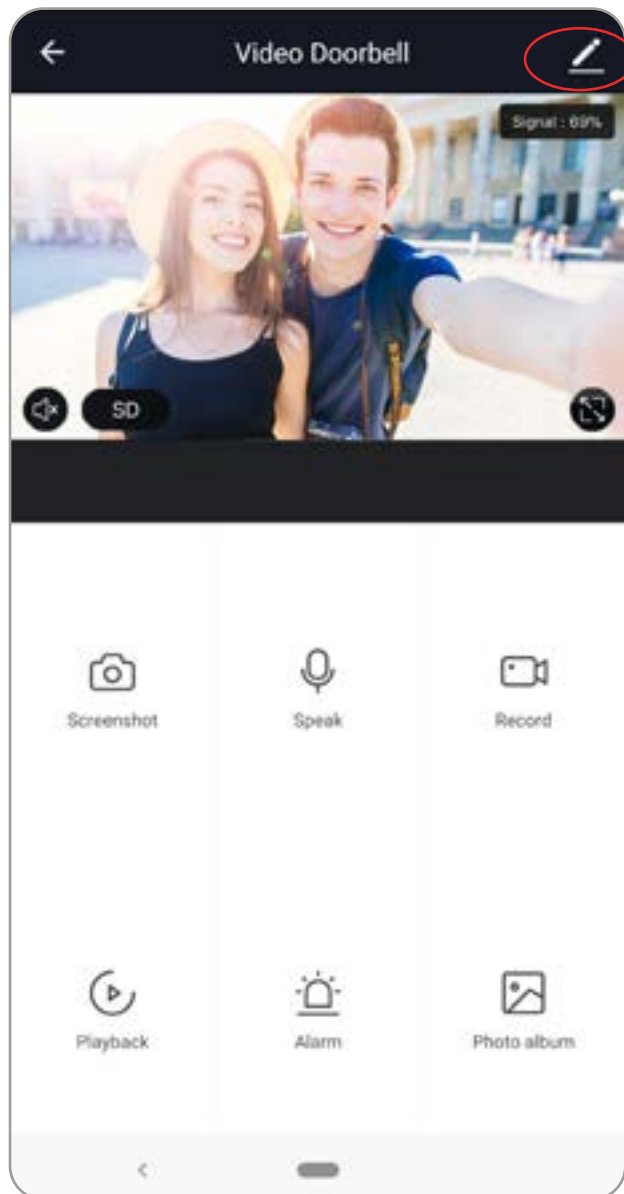

[No. 10 Trouble shooting](#)

[No. 11 Specifications](#)



Control device

From this page, all device settings can be altered.

Tap the edit symbol :  or  to make changes in name, location, share device, Bell Settings, Motion Detection etc.

If there is a firmware update available, check under 'Firmware information' to update the firmware.



Index:

[No. 1 Caliber Smart Home app](#)

[No. 2 Register / Login](#)

[No. 3 Install device](#)

[No. 4 Add device\('s\)](#)

[No. 5 Install Chime](#)

[No. 6 Control device](#)

[No. 7 Profile](#)

[No. 8 Scene's & Automation](#)

[No. 9 Voice control](#)

[No. 10 Trouble shooting](#)

[No. 11 Specifications](#)

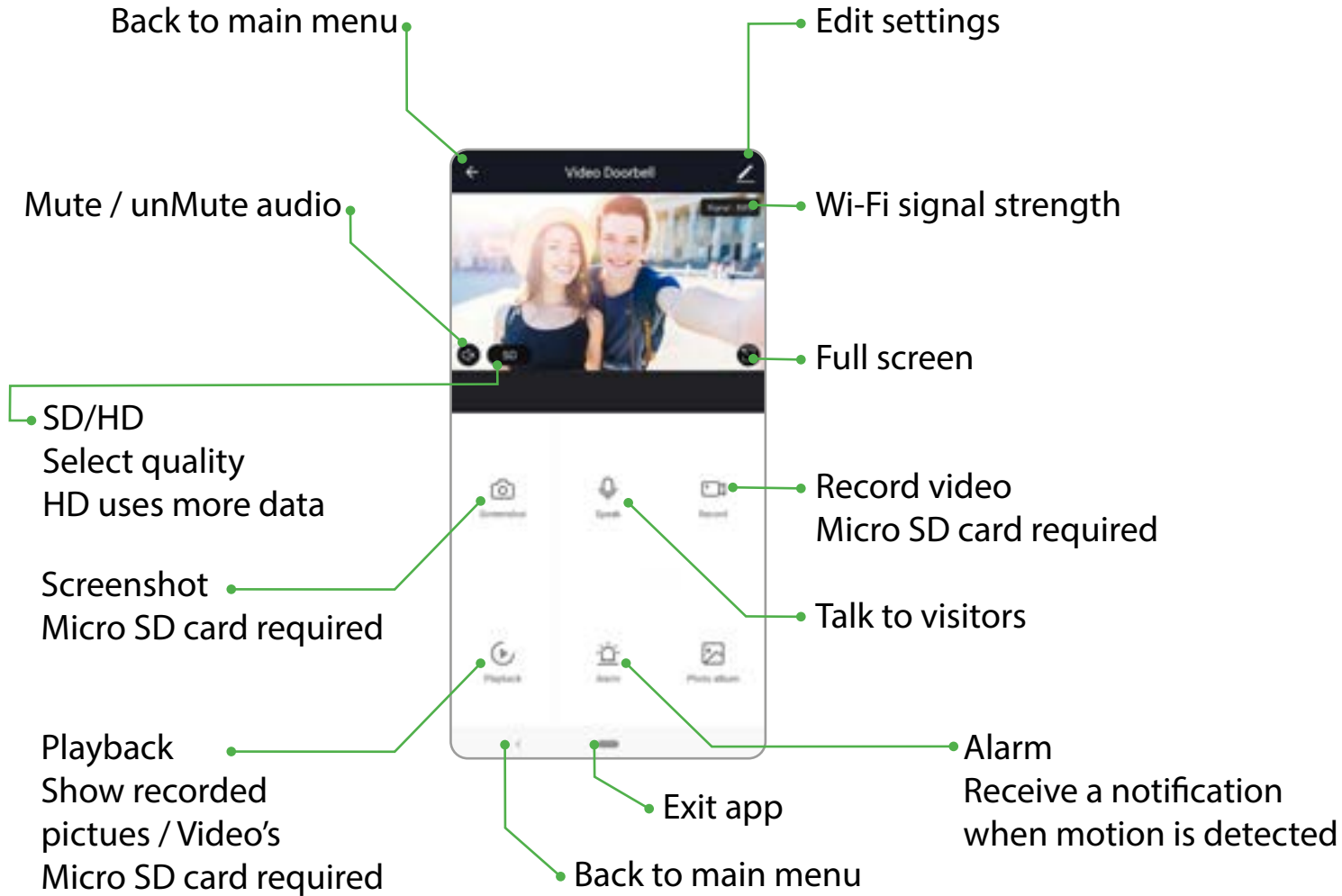

Index:

[No. 1 Caliber Smart Home app](#)

[No. 2 Register / Login](#)

[No. 3 Install device](#)

[No. 4 Add device\(s\)](#)

[No. 5 Install Chime](#)

[No. 6 Control device](#)

[No. 7 Profile](#)

[No. 8 Scene's & Automation](#)

[No. 9 Voice control](#)

[No. 10 Trouble shooting](#)

[No. 11 Specifications](#)

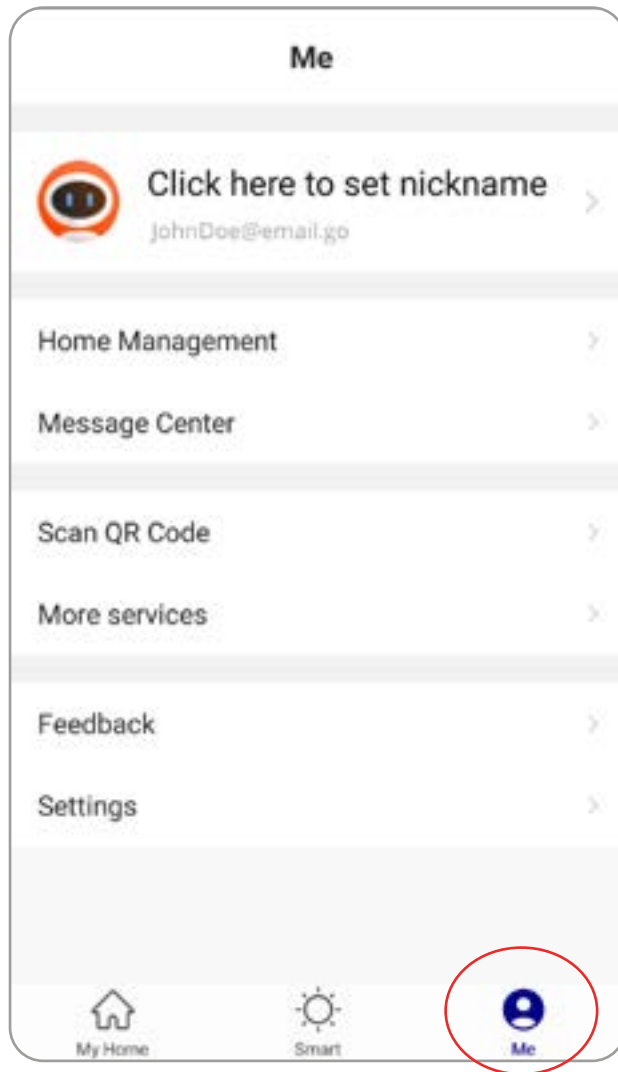

Profile (Me)

In order to make full use of the functionality of this app and your Caliber Smart Home devices, make your home situation match the situation in the app.

1. Choose family name
2. Manage your rooms
3. Set the location, for area automations
4. Add members to the family

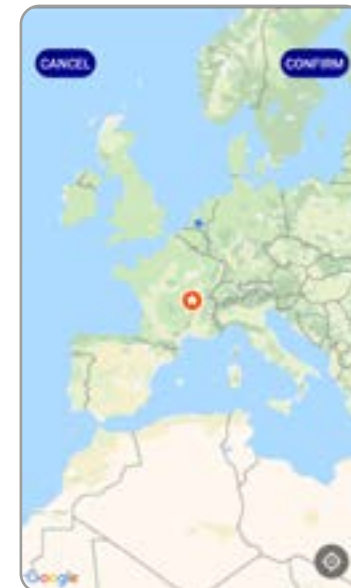
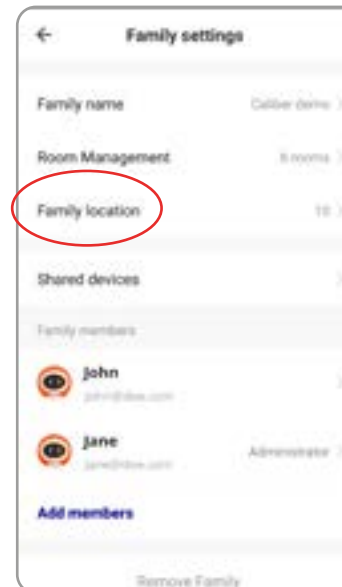

Index:

[No. 1 Caliber Smart Home app](#)

[No. 2 Register / Login](#)

[No. 3 Install device](#)

[No. 4 Add device\(s\)](#)

[No. 5 Install Chime](#)

[No. 6 Control device](#)

[No. 7 Profile](#)

[No. 8 Scene's & Automation](#)

[No. 9 Voice control](#)

[No. 10 Trouble shooting](#)

[No. 11 Specifications](#)

Scene's

You can combine devices to do 'tasks' in a "scene". Go to Smart (img1)

The next pages describes general information. Some products cannot preform scene's

1. Tap "+" in the upper right of the page to create a new smart scene.
2. Tap "scene" img 2
3. Enter life scene name, add task, tap "Save", as shown in the picture. A smart scene has been created.
3. You can also change the scene you have already created (img1) , change scene name, change task or delete smart scene etc.

Index:

[No. 1 Caliber Smart Home app](#)

[No. 2 Register / Login](#)

[No. 3 Install device](#)

[No. 4 Add device\('s\)](#)

[No. 5 Install Chime](#)

[No. 6 Control device](#)

[No. 7 Profile](#)

[No. 8 Scene's & Automation](#)

[No. 9 Voice control](#)

[No. 10 Trouble shooting](#)

[No. 11 Specifications](#)

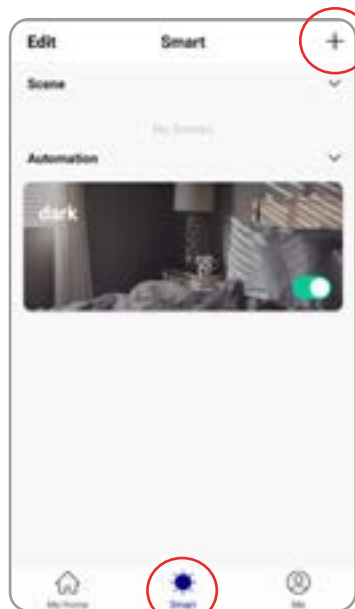

img 1

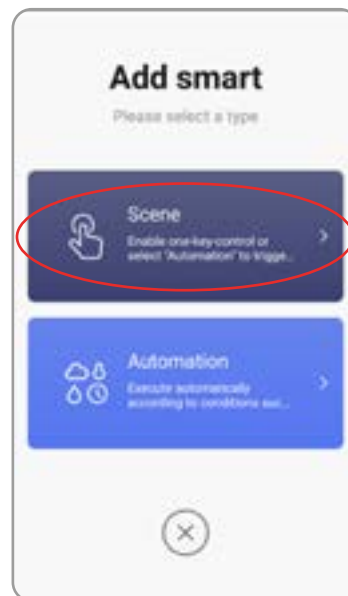

img 2

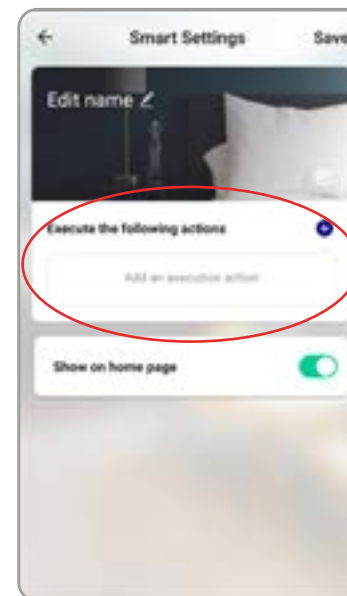

img 3

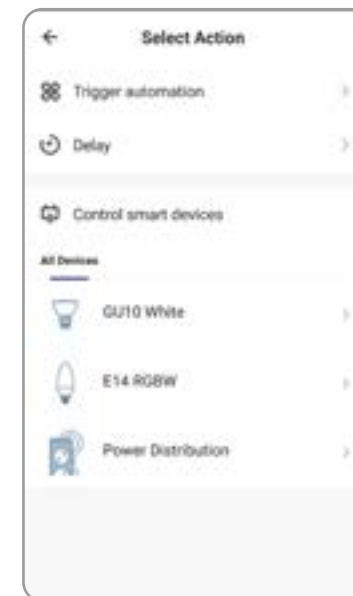

img 4

Automation

You can execute automations, when conditions are met.

1. Tap "+" in the upper right of the page to create a new smart scene
2. Tap "Automation"
3. Choose which conditions should be met "img3".
4. Choose what 'task /action' should be executed "img3".
5. img4 shows an example (This might include a different product). The Smart light group "E27 RGBW" switches ON when the sun sets. For this function you need to set your location, see [profile](#).

[More app functions can be found in our support page](#)

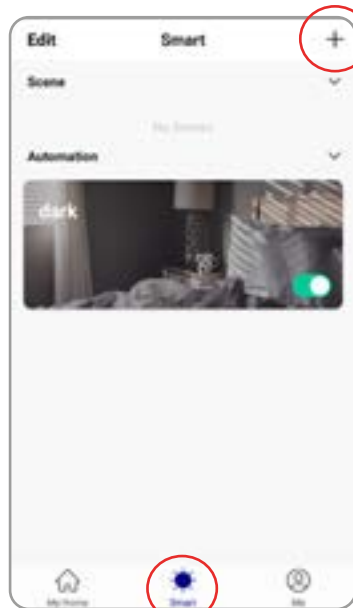

img 1

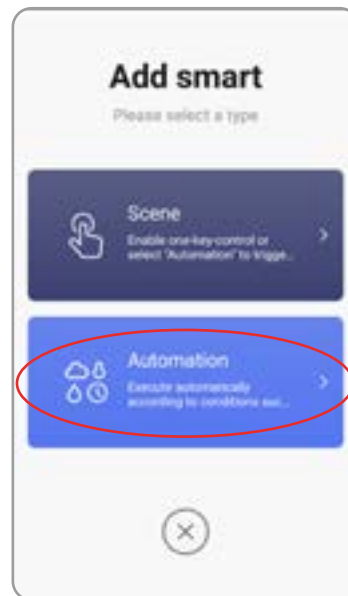

img 2

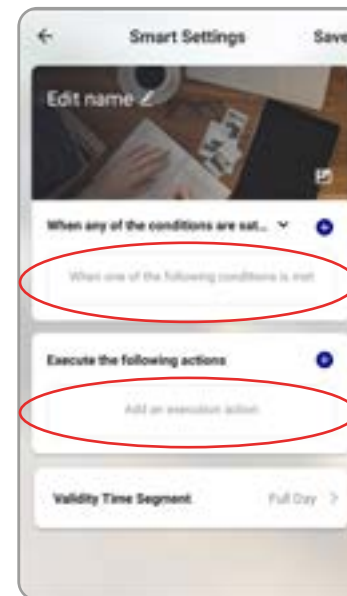

img 3

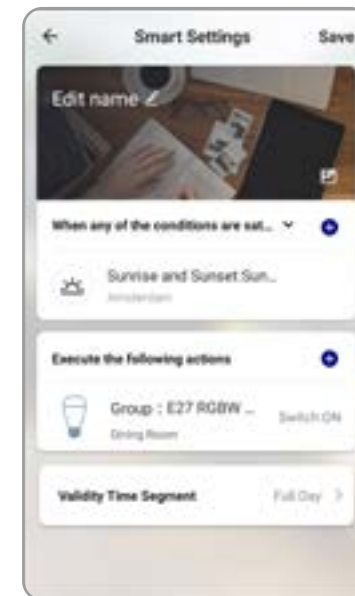

img 4

Index:

[No. 1 Caliber Smart Home app](#)

[No. 2 Register / Login](#)

[No. 3 Install device](#)

[No. 4 Add device\(s\)](#)

[No. 5 Install Chime](#)

[No. 6 Control device](#)

[No. 7 Profile](#)

[No. 8 Scene's & Automation](#)

[No. 9 Voice control](#)

[No. 10 Trouble shooting](#)

[No. 11 Specifications](#)

Voice control

Most of our Smart Home products support 3rd party voice control. Instructions how to connect can be found in the links below:

Connect with Google Home

[Webshop.caliber.nl/media/SmartHome/Caliber in GoogleHome.pdf](http://Webshop.caliber.nl/media/SmartHome/Caliber_in_GoogleHome.pdf)

Connect with Amazon Alexa

[Webshop.caliber.nl/media/SmartHome/Caliber with Amazon-Alexa.pdf](http://Webshop.caliber.nl/media/SmartHome/Caliber_with_Amazon-Alexa.pdf)

Index:

[No. 1 Caliber Smart Home app](#)

[No. 2 Register / Login](#)

[No. 3 Install device](#)

[No. 4 Add device\(s\)](#)

[No. 5 Install Chime](#)

[No. 6 Control device](#)

[No. 7 Profile](#)

[No. 8 Scene's & Automation](#)

[No. 9 Voice control](#)

[No. 10 Trouble shooting](#)

[No. 11 Specifications](#)

Possible reasons why a device cannot be added:

1. The device is not powered on
2. WiFi signal is strong and stable, distance between device and router should be not too far
3. The smartphone cannot connect to WiFi
4. Wifi password not correct
5. The device is in configuration state (When a device needs to be added, you need to bring it into WiFi configuration state)
6. You selected a 5GHz network (with dual band routers) Devices only support 2.4GHz network

Router issues:

1. Encryption mode should be WPA2-PSK type, Authentication type AEX or set to "automatic".
2. Wireless mode cannot be 11n only
3. Max number of connected devices has reached upper limit of router. Disconnect other devices from WiFi

Index:[No. 1 Caliber Smart Home app](#)[No. 2 Register / Login](#)[No. 3 Install device](#)[No. 4 Add device\('s\)](#)[No. 5 Install Chime](#)[No. 6 Control device](#)[No. 7 Profile](#)[No. 8 Scene's & Automation](#)[No. 9 Voice control](#)[No. 10 Trouble shooting](#)[No. 11 Specifications](#)

1. PRODUCT DESCRIPTION

WiFi wireless Door/ Window sensor. It can monitor the status of door / window after proper installation with your smart phone. When it is triggered, such as open, close or tampered, a push notification will be reported to your smart phone.

2. FEATURES

- Works with Amazon Alexa
- Works with Google assistant
- Works with IFTTT
- Working in 2.4G wireless Wi-Fi
- Send notification about 'tampered' event
- Detects the battery level
- Low battery level alarm
- Open/Close history record and record clear

Image sensor	1/3inch 1080p CMOS sensor
Viewing angle	120°
Compression Format	H.264 Main Profile
Night vision	IR power LED
Max.Frame rate	1-25fps
Audio Input	Two way audio Full duplex
Network Protocol	HTTP,DHCP,DNS
WIFI	WiFi802.11b/g/n
	Freq range: 2402-2480 Mhz
	Max e.r.p: <100mW/20dBm
Storage mode	Local storage
Interface	Micro SD/TF, support up to 128GB SD
Optional accessories	Wireless chime, mechanical chime
Motion detection	Support motion detection
Power	8-16V AC trough power converter
Working environment	Working Temperature -20~50°C
Camera size	45mm (L) x 26mm (W)x115mm (H)
Installation	Wall mounting
IP rated	IP54

Set consists of: HWC502
Manual
Mounting material

We are continuously improving / updating our products and product information. It's therefore possible that there is a slight difference between the description in this manual to the operation of the product.
If something is different or not clear; always check our website for the most current manual version. The (app) images and illustrations used are indicative and may vary per device and version

Index:

[No. 1 Caliber Smart Home app](#)

[No. 2 Register / Login](#)

[No. 3 Install device](#)

[No. 4 Add device\('s\)](#)

[No. 5 Install Chime](#)

[No. 6 Control device](#)

[No. 7 Profile](#)

[No. 8 Scene's & Automation](#)

[No. 9 Voice control](#)

[No. 10 Trouble shooting](#)

[No. 11 Specifications](#)

All rights reserved

The pictures used in this manual are Android app interface, iOS version is a bit different

Product and software update periodically, the number and app interface in this manual are only shown as an example. No extra notification on further changes.

Wifi Freq range: 2402-2480 Mhz, Max e.r.p: <100mW/20dBm

The Apple logo is a trademark of Apple Inc., registered in the U.S. and other countries.

Tuya word mark and logos are registered trademarks owned by Tuya, Inc. and any use of such marks by Caliber Europe BV is under license. Other trademarks and trade names are those of their respective owners.

Google Play and the Google Play logo are trademarks of Google LLC.

Amazon Alexa logo are trademarks of Amazon Alexa.

IFTTT logo are trademarks of IFTTT.

Index:

[No. 1 Caliber Smart Home app](#)

[No. 2 Register / Login](#)

[No. 3 Install device](#)

[No. 4 Add device\('s\)](#)

[No. 5 Install Chime](#)

[No. 6 Control device](#)

[No. 7 Profile](#)

[No. 8 Scene's & Automation](#)

[No. 9 Voice control](#)

[No. 10 Trouble shooting](#)

[No. 11 Specifications](#)

Thank you!

Explore our growing number of
smart home products

