









Buttons & Functions:		
Button	Functions	
Red Button	Power On/Off, reject call, end call	
Blue Button	Pairing, voicemail, answer call, last number redial, transfer call, connect mobile phones	
LED Indication:		
Car kit status	Blue LED indicate	Red LED indicate
Standby		Flash every 3 seconds
Idle	Flash every 3 seconds	Bright
Telephone conversation	Flash every 3 seconds	Bright
Pairing in progress	Blue and red LED flash one by one	
Operations:		
Current State	Want to	Actions step by step
Device off short	Turn on	Press and hold  until you hear two "beep" sounds. After power on, the car kit will try to connect to "last connected AG"
	Pair	Refer to "Direction for first use"
Device On short	Turn off	Press and hold  until you hear two "beep" sounds
Standby	Voicemail	(First Make sure your Bluetooth mobile has voice recognition feature) Short press  and then speak some one's name in your phonebook
	Last number redial	Press and hold  until you hear two short "beep" sounds. If the phone is connected, the operation will be on 'last used phone'.
Incoming call	Answer	Short press 
	Reject	Short press 
When calling	End call	Short press 
When calling	Shift to mobile phone /carkit	Short press  to switch between your mobile phone and carkit
Connection lost (prompted by hand set)	Reconnect to handset	Short press 



HFB 200



GB ENGLISH

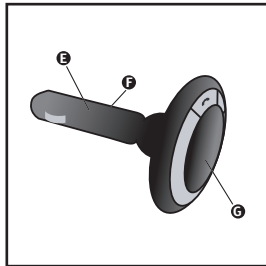
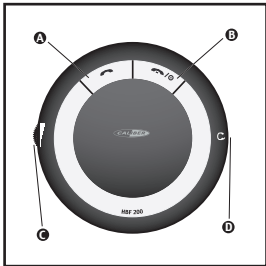
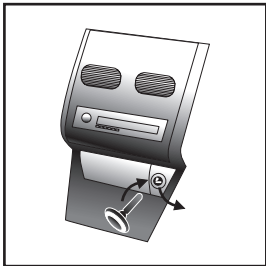

- A** Blue button
- B** Red button
- C** Volume
- D** Earphone
- E** Light
- F** Microphone
- G** Speaker

Direction for first use:

1. Plug the handsfree car kit into the cigarette lighter hole, the car kit will power on in several seconds.
2. Press and hold / until you hear two short "beep" sounds, the car kit will come into standby as the red LED flashes every 3 seconds.
3. Press and hold until you hear two continuous short "beep" sounds, then the blue and red LED flash one by one indicating pairing mode.
4. Activate your mobile phone Bluetooth function please check the mobile phone user guide for details. Meanwhile, the handset will search for accessible Bluetooth devices.
5. Select "SSTB601" from the list in your mobile phone.
6. Enter the pre-programmed passkey "8888" (based on your mobile configuration) and press "OK" to pair the car kit and the handset. When pairing is completed, you will hear a short beep, then a blue light flashes every 3 seconds.
7. To switch between your handsfree carkit and your handset press shortly .

F FRANCAIS

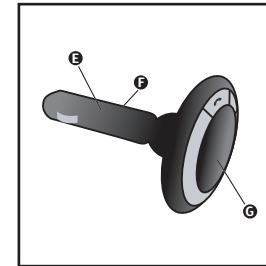
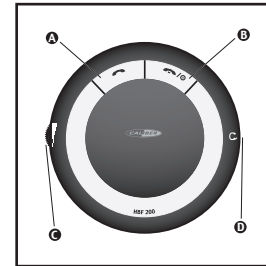
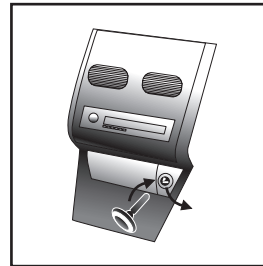

- A** Bouton bleu
- B** Bouton rouge
- C** Volume
- D** Oreillettes
- E** Lumière
- F** Micro
- G** Haut parleur

Indications pour la première utilisation

1. Branchez votre kit mains libres sur la prise allume cigares, le kit mains libres se mettra en marche en quelques secondes.
2. Pressez et maintenez / jusqu'à ce que vous entendiez deux bips, le kit mains libres se mettra en veille dès l'instant où la LED rouge clignotera toutes les 3 secondes.
3. Pressez et maintenez jusqu'à ce que vous entendiez deux bips continus, ensuite les LEDs bleue et rouge clignoteront chacune leur tour indiquant le mode de couplage.
4. Activez la fonction Bluetooth de votre téléphone portable (vérifiez le manuel d'utilisation de votre téléphone pour plus d'infos). Le kit mains libres recherchera alors les appareils équipés de la fonction bluetooth.
5. Sélectionnez "SSTB601" sur la liste apparaissant sur votre téléphone portable.
6. Entrez le code pré-programmé « 8888 » (basé sur la configuration de votre portable) et pressez « OK » afin de coupler votre téléphone portable au kit mains libres. Lorsque le couplage est effectué, vous entendrez un court bip et la lumière bleue clignotera toutes les 3 secondes.
7. Afin de passer du kit mains libres à votre téléphone, pressez rapidement .

D DEUTSCH

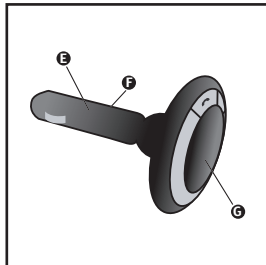
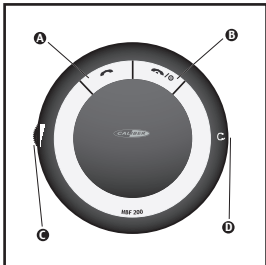
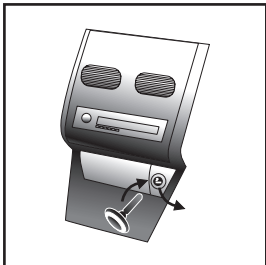

- A** Blaue Taste
- B** Rote Taste
- C** Lautstärke
- D** Kopfhörer
- E** Licht
- F** Mikrofon
- G** Lautsprecher

Anweisungen zum ersten Gebrauch:

1. Stecken Sie die Freisprecheinrichtung in den Zigarettenanzünder, die Freisprecheinrichtung schaltet sich nach wenigen ein.
2. Drücken und halten Sie / bis Sie zwei kurze Pieptöne hören, die Freisprecheinrichtung geht in Standby sobald das rote LED alle 3 Sekunden blinkt.
3. Drücken und halten Sie bis Sie zwei lange Pieptöne hören, dann blinken das blaue und rote LED abwechselnd und zeigen an, dass sie miteinander verbunden sind.
4. Aktivieren Sie Ihre Mobiltelefon-Bluetooth-Funktion, für Details bitte sehen Sie in der Bedienungsanleitung Ihres Mobiltelefons nach. Inzwischen sucht der Hörer nach erreichbaren Bluetooth-Geräten.
5. Wählen Sie "SSTB601" aus der Liste in Ihrem Mobiltelefon.
6. Geben Sie das vorprogrammierte Passwort "8888" ein (basierend auf Ihrer Mobilkonfiguration) und drücken Sie "OK", um die Freisprecheinrichtung mit dem Hörer zu verbinden. Wenn die Verbindung besteht, hören Sie einen kurzen Piepton und das blaue LED blinkt alle 3 Sekunden.
7. Drücken Sie kurz , um zwischen Ihrer Freisprecheinrichtung und Ihrem Hörer umzuschalten .

NL NEDERLANDS

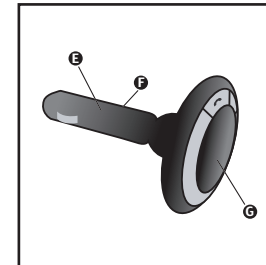
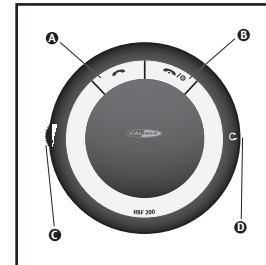
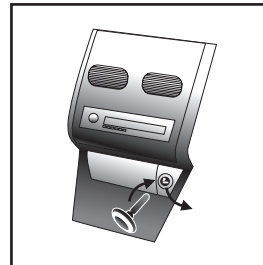

- A** Blauwe knop
- B** Rode knop
- C** Volume
- D** Hoofdtelefoon
- E** Licht
- F** Microfoon
- G** Luidspreker

Aanwijzingen voor eerste gebruik:

1. Sluit de handsfree car kit aan op de aansluiting van de sigarettenaansteker, de car kit wordt binnen een paar seconden geactiveerd.
2. Druk en houdt de / toets vast totdat u twee korte "piepjes" hoort, de car kit is overgeschakeld naar standby, de rode LED knippert elke 3 seconde.
3. Druk en houdt de toets vast totdat u twee "piepjes" aaneensluitend hoort, hierna zullen de blauwe en de rode LED om en om knipperen waarmee pairing (koppel) mode wordt aangegeven.
4. Activeer de bluetooth functie van de mobiele telefoon, voor meer uitleg hierover raadpleeg de handleiding van de mobiele telefoon. Ondertussen is de telefoon op zoek naar beschikbare Bluetooth apparaten.
5. Selecteer "SSTB601" uit de lijst in de telefoon.
6. Voer de voorgeprogrammeerde code "8888" in (gebaseerd op de configuratie van de mobiele telefoon) druk hierna "OK" om de car kit en de telefoon te paren (koppelen). Wanneer het paren compleet is, hoort u een kort geluid, en de blauwe LED knippert om de 3 seconden.
7. Om te schakelen tussen car kit en telefoon drukt u kort op de toets.