

USER MANUAL

Specifications

Battery Capacity	10000mAh
Type-C Input	5V≐3A 9V≐2A 12V≐1.5A
Type-C Output	5V≐3A 9V≐2.22A 12V≐1.5A
USB Output1	5V≐4.5A 9V≐2.5A
USB Output2	5V≐3A 9V≐2A 12V≐1.5A
Wireless Output	15W/10W/7.5W/5W
Dimensions	147.5x70.5x17 mm

Package Contents



Power Bank x1



Charging Cable x1



User Manual x1

Product Features

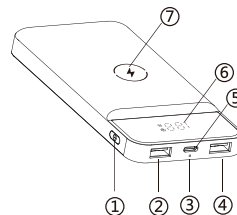

1. Power Button
2. USB Output2
3. LED indicator
4. USB Output1
5. Type-C Input and Output Port
6. LED Display Panel
7. Wireless Charging Area

Operating Instructions

1.Charging the Power Bank

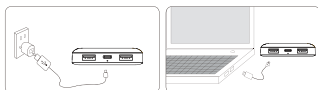

1). Connect the included Type-C charging cable between power bank and the wall charger or power adapter (not included). It will start charging automatically. If the power bank is quick charge 22.5W version, It's recommend to use the PD22.5W wall charger or power adapter to match the fast charging.

2). During charging the power bank, the LED display indicates the available battery capacity percentage. If the LED display panel shows 100%, It means the power bank is fully charged.

Note: Fully charge the power bank before using the power bank for the first time. Recharge the power bank once every three months when not in use or seldom used.

2. Charging the device



1). Wired Charging

Press the power button, the LED Display is on. Connect the charging cable between the power bank and the device to start charging. During charging the device, LED Display is always on.

2). Wireless charging (Optional)

Place the device in the center of the wireless charging area.

Press the power button, the LED Display and the LED indicator are on, which means wireless charging is in progress.

Note: Make sure your device is fit for Qi standard receiving equipment.

Troubleshooting

- 1.Press the power button, if the LED display shows '00' and flashes, It means the battery has run out of power, please recharge.
- 2.This power bank can automatically identify equipment that need to charge. If no device is being charged, the power bank will be turned off after 30 seconds.
- 3.For wireless charging, your device must be equipped with a Qi wireless receiver. The device can automatically identify a Qi-compatible device placed on it. If the center point of the receiving terminal is deflected over 8mm from the center point of transmitting terminal, the power bank will turn off automatically.
- 4.If wired charging is not working properly, please try a different charging cable, since the connector may become loose due to

wearing.

5. During charging, the device may become warm due to high currents and resistance, especially during wireless charging. To reduce temperature, avoid running intensive applications or using GPS on your mobile device when charging.

Cautions

- 1.The power bank will generate heat when charging. Always charge in a well-ventilated and open-air area.
- 2.Do not charge under pillows, blankets, clothing or on flammable surfaces. Keep the power bank away from heat sources, direct sunlight, combustible gas, humidity, water or other liquids.
- 3.Do not disassemble, open, microwave, incinerate, paint or insert foreign objects into the power bank.
- 4.Do not subject the power bank to mechanical shock such as crushing, bending, puncturing or shredding. Avoid dropping or placing heavy objects on the power bank.
- 5.Do not short-circuit the power bank or store it in a receptacle where it may be short-circuited by other metallic or conductive objects.
- 6.Do not operate the power bank if it has been wet or otherwise damaged, to prevent against electric shock, explosion and/or injury.
- 7.The maximum operating temperature of this product does not exceed 45 C.